

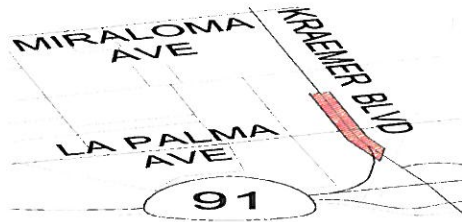

**CITY OF ANAHEIM
CONSTRUCTION NOTICE
PUBLIC WORKS PROJECT**



WHERE: Intersection of Kraemer Boulevard & La Palma Avenue

BEGINS: August 24, 2009

COMPLETION: March 18, 2010

TYPE OF WORK: Intersection widening including: pavement reconstruction; construction of retaining walls; construction of sidewalks, driveways, bus pads, access ramps, median islands, curbs, and gutters; drainage improvements; traffic signal and street light improvements; installation of irrigation system; and landscape improvements.

TRAFFIC IMPACT: During the construction, there will be Traffic Lane Closures; therefore, traffic disruptions shall be expected. "No-Parking" signs will be posted in advance to restrict parking in the construction zones.

CONTRACTOR: GMC Engineering, Inc.
SUPERINTENDENT: Mike Irvin 714-412-0070
CITY INSPECTOR: Daryl Lopez 714-231-8374

The City will be working with the contractor to complete the project with minimum inconvenience to you.
Thank you for your cooperation