

HESS & NGHIEM
A Partnership of Professional Corporations

Edward W. Hess, Jr.*
Phillip B. Nghiem

SANTA ANA, CALIFORNIA 92705

* Member
American Board of Trial
Advocates

PUBLIC RECORDS REQUEST

October 24, 2018

Anaheim City Clerk
Office of the City Clerk
200 S. Anaheim Blvd., Suite 217
Anaheim, CA 92805
Via email to: landal@anahiem.net

Orange County Clerk-Recorder
12 Civic Center Plaza, Room 101
Santa Ana, CA 92701
Via facsimile only to: 714-834-2575

Incident Date: 10/03/2018
Incident Location: La Palma Avenue and Mosswood Drive, Anaheim, CA
Time: 16:55
GO #: 2018-153417

Dear Sir or Madam:

This office is investigating an incident that took place on October 3, 2018 at the intersection of La Palma Avenue and Mosswood Drive in Anaheim, California. A copy of the Traffic Collision Report is attached for your reference. To assist our investigation, we require the documentation as outlined more fully below.

We respectfully request this documentation in accordance with the California Public Records Act. Please contact me if additional information is required by you to respond to my request or if, for any reason, the requests below are unclear or if you require further clarification as to what we are requesting. If, for some reason, you are currently unable to release all the documents we are requesting at this time, please identify those documents that cannot be released and the reasons behind withholding said documents.

DEFINITIONS

For purposes of the following requests, the term "DOCUMENT" means all handwritten, printed, photostat, recorded, written, graphic, photographic, magnetic, or electronic matter (including, without limitation, audio and/or video tape recordings, electronic mail and material for computer use), including all original and duplicates and includes the original or a copy of handwriting, typewriting, printing and every other means of recording upon any tangible thing and form of communicating or representation including computer hard disks, letters, words, pictures, sounds, or symbols or combinations of them.

Please provide us with the following:

1. All DOCUMENTS that relate to, refer to, or memorialize any inspection made by the City of Anaheim of any of the trees located on La Palma Avenue between Fairmount Boulevard and Brookdale Lane in Anaheim, CA from 2010 to the present.
2. All DOCUMENTS that relate to, refer to, or memorialize any code violations regarding the trees located on La Palma Avenue between Fairmount Boulevard and Brookdale Lane in Anaheim, CA from 2010 to the present
3. Any reports employees prepared in connection with any tree falling incidents located at the intersection on La Palma Avenue between Fairmount Boulevard and Brookdale Lane in Anaheim, CA from 2010 to the present
4. Any photos referenced in the Anaheim Police Department GO Report #: 2018-153417.
5. Any complaints or claims filed with the City of Anaheim in connection with any tree falling incidents located on La Palma Avenue between Fairmount Boulevard and Brookdale Lane in Anaheim, CA from 2010 to the present
6. All DOCUMENTS that relate to, refer to, or memorialize any procedures or policies the City of Anaheim has for maintaining the trees located on La Palma Avenue between Fairmount Boulevard and Brookdale Lane in Anaheim, CA from 2010 to the present
7. All DOCUMENTS that relate to, refer to, or memorialize any procedures or policies the City of Anaheim for inspecting the trees located on La Palma Avenue between Fairmount Boulevard and Brookdale Lane in Anaheim, CA from 2010 to the present
8. All DOCUMENTS that relate to, refer to, or memorialize any costs incurred by the City of Anaheim in connection with the maintenance of the trees located on La Palma Avenue between Fairmount Boulevard and Brookdale Lane in Anaheim, CA from 2010 to the present

9. All witness statements given by any persons, employees, or any other witnesses to the tree falling incident that occurred on October 3, 2018 on La Palma Avenue between Fairmount Boulevard and Brookdale Lane in Anaheim, CA from 2010 to the present
10. Any reports made by West Coast Arborist in connection with the tree falling incident that occurred on October 3, 2018 on La Palma Avenue between Fairmount Boulevard and Brookdale Lane in Anaheim, CA from 2010 to the present
11. Any reports made by any arborists in connection with any tree falling incident on La Palma Avenue between Fairmount Boulevard and Brookdale Lane in Anaheim, CA from 2010 to the present

Your prompt attention to this matter is greatly appreciated. You may e-mail the requested records to the following e-mail address: or send an electronic
version of the records to our office. Alternatively, if there are charges for your services or for the records, contact me and I will remit the required payment by check to you immediately.

Please contact me if you have any questions or concerns.

Hess & Nghiem
A Professional Corporation

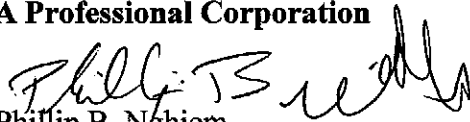
Phillip B. Nghiem

PBN; pn



City of Anaheim
 Office of the City Clerk
 200 S. Anaheim Blvd., Suite 217
 Anaheim, CA 92805
 (714) 765-5166 • fax (714) 765-4105
www.anaheim.net

REQUEST FOR PUBLIC RECORDS

STEP 1: COMPLETE all fields on this form. This form is to facilitate and expedite the processing of your public records request. Describe identifiable records in the possession of the City; your request must be sufficiently focused and specific to allow the City to locate the requested record(s).

STEP 2: SUBMIT completed form by mail, fax, email or in person to Custodian of Records, Office of the City Clerk, 200 S. Anaheim Blvd. (714) 765-5166; landal@anaheim.net; fax (714) 765-4105.

STEP 3: WAIT to receive an invoice for responsive records. The City shall determine within 10-days from receipt of a public records request, whether the request, in whole or in part, seeks copies of discloseable public records in possession of the City [GC 6253(c)]. Please note that if you are requesting the opportunity to inspect records, you will be requested to make an appointment to return at a later date/time to view the documents.

Charges for the direct cost of duplication will apply. **Documents will not be copied until payment has been received.** If payment is not received within 10 days after invoice is sent, you may be required to submit a new request. Please see backside for additional information.

REQUESTER INFORMATION

Full Name : Phillip B. Nghiem Date: 10/24/2018

Company Name: Hess & Nghiem

(Mailing) Address: _____ City/State/Zip Code: Santa Ana, CA 92705

Phone number: _____ Email: _____

Preferred method of contact in the event of questions: _____

DESCRIPTION OF REQUESTED RECORD(S): (Describe the specific public record(s) e.g., date, type, time period covering documents requested etc)

See attached correspondence.

I understand that I will be contacted once documents have been identified. If production of records is requested, an estimated cost will be provided to me and I agree that I will be required to submit payment for duplication costs (and mailing) prior to the production of the requested documents.

I wish to inspect City records Will Pick-Up Records Please Mail

Please note that information contained in any PRA request is a public record and may be subject to public inspection pursuant to the CA Public Records Act.

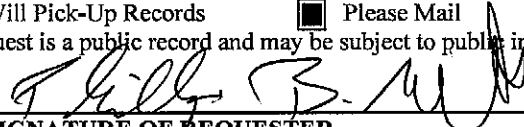

 SIGNATURE OF REQUESTER



ANAHEIM POLICE DEPARTMENT

GO# 2018-153417
CLOSED - NO FURTHER
ACTION

GENERAL OFFENSE HARDCOPY

OTHER AUTHORIZED

(TRAFFIC-0 TRAFFIC COLLISION/INJURY-901)

Related Attachment - General Offense Report

Description TRAFFIC COLLISION REPORT

Reference Number

TRAFFIC OCT 05 2018

STATE OF CALIFORNIA
DEPARTMENT OF CALIFORNIA HIGHWAY PATROL
TRAFFIC COLLISION REPORT
CHP 555 Page 1 (Rev. 4-11) OPI 060

Page 1 of 5

SPECIAL CONDITIONS		NUMBER INJURED 1	HIT & RUN PELODY <input type="checkbox"/>	CITY ANAHEIM	JUDICIAL DISTRICT NJ	LOCAL REPORT NUMBER 18-153417			
NUMBER CALLED 0		HIT & RUN MISDEMEANOR <input type="checkbox"/>	COUNTY ORANGE	REPORTING DISTRICT D4	BEAT S 1140 F S	DAY OF WEEK SUNDAY	TOW AWAY <input checked="" type="checkbox"/> YES <input type="checkbox"/> NO		
LOCATION	COLLISION OCCURRED ON (E) LA PALMA AVE		MO. DAY YEAR 10-3-18	TIME (2400) 1655	NCIC # 3001	OFFICER I.D. 1032			
	MILEPOST INFORMATION		GPS COORDINATES		PHOTOGRAPHS BY: <input type="checkbox"/> NONE S. FLANNIFF				
	FEET/MILES OF		LATITUDE		LONGITUDE				
	AT INTERSECTION WITH R 445 FEET/MILES E. OF (N) MOSCADO DR.		STATE HWY REL. <input type="checkbox"/> YES <input checked="" type="checkbox"/> NO						
PARTY 1	DRIVERS LICENSE NUMBER	STATE	CLASS	AIR BAG	SAFETY EQUIP.	VEH. YEAR	MAKE/MODEL/COLOR	LICENSE NUMBER	STATE
DRIVER	NAME (FIRST, MIDDLE, LAST) JULIE LEO								
PEDESTRIAN	STREET ADDRESS								
PARKED VEHICLE	CITY/STATE/ZIP YORBA LINDA, CA 92886								
BIKE/CLIST	SEX	HAIR	EYES	HEIGHT	WEIGHT	BIRTHDATE	RACE	DISPOSITION OF VEHICLE ON ORDERS OF: <input type="checkbox"/> OFFICER <input checked="" type="checkbox"/> DRIVER <input type="checkbox"/> OTHER	
OTHER	HOME PHONE		BUSINESS PHONE		PRIOR MECHANICAL DEFECTS: <input checked="" type="checkbox"/> NONE APPARENT <input type="checkbox"/> REFER TO NARRATIVE				
INSURANCE CARRIER		POLICY NUMBER							
DIR OF TRAVEL		ON STREET OR HIGHWAY		SPEED LIMIT					
PARTY 2	DRIVERS LICENSE NUMBER	STATE	CLASS	AIR BAG	SAFETY EQUIP.	VEH. YEAR	MAKE/MODEL/COLOR	LICENSE NUMBER	STATE
DRIVER	NAME (FIRST, MIDDLE, LAST)								
PEDESTRIAN	STREET ADDRESS								
PARKED VEHICLE	CITY/STATE/ZIP								
BIKE/CLIST	SEX	HAIR	EYES	HEIGHT	WEIGHT	BIRTHDATE	RACE	DISPOSITION OF VEHICLE ON ORDERS OF: <input type="checkbox"/> OFFICER <input type="checkbox"/> DRIVER <input type="checkbox"/> OTHER	
OTHER	HOME PHONE		BUSINESS PHONE		PRIOR MECHANICAL DEFECTS: <input type="checkbox"/> NONE APPARENT <input type="checkbox"/> REFER TO NARRATIVE				
INSURANCE CARRIER		POLICY NUMBER							
DIR OF TRAVEL		ON STREET OR HIGHWAY		SPEED LIMIT					
PARTY 3	DRIVERS LICENSE NUMBER	STATE	CLASS	AIR BAG	SAFETY EQUIP.	VEH. YEAR	MAKE/MODEL/COLOR	LICENSE NUMBER	STATE
DRIVER	NAME (FIRST, MIDDLE, LAST)								
PEDESTRIAN	STREET ADDRESS								
PARKED VEHICLE	CITY/STATE/ZIP								
BIKE/CLIST	SEX	HAIR	EYES	HEIGHT	WEIGHT	BIRTHDATE	RACE	DISPOSITION OF VEHICLE ON ORDERS OF: <input type="checkbox"/> OFFICER <input type="checkbox"/> DRIVER <input type="checkbox"/> OTHER	
OTHER	HOME PHONE		BUSINESS PHONE		PRIOR MECHANICAL DEFECTS: <input type="checkbox"/> NONE APPARENT <input type="checkbox"/> REFER TO NARRATIVE				
INSURANCE CARRIER		POLICY NUMBER							
DIR OF TRAVEL		ON STREET OR HIGHWAY		SPEED LIMIT					
PREPARERS NAME C. EPYANT #1032		DISPATCH NOTIFIED <input type="checkbox"/> YES <input type="checkbox"/> NO <input checked="" type="checkbox"/> N/A		REVIEWERS NAME R. ...		DATE REVIEWED 10/05/18		CHP 555_0411.pdf	



ANAHEIM POLICE DEPARTMENT

GO# 2018-153417
CLOSED - NO FURTHER
ACTION

GENERAL OFFENSE HARDCOPY OTHER AUTHORIZED (TRAFFIC-0 TRAFFIC COLLISION/INJURY-901)

STATE OF CALIFORNIA
DEPARTMENT OF CALIFORNIA HIGHWAY PATROL
TRAFFIC COLLISION CODING
CHP 555 Page 2 (Rev. 4-11) OPI 060

Page 2 of 5

DATE OF COLLISION (MO. DAY YEAR) 10-3-18	TIME (2400) 1655	NCIC # 3001	OFFICER I.D. 1032	NUMBER 18-153417
OWNERS NAME		OWNERS ADDRESS		
PROPERTY DAMAGE		NOTIFIED <input type="checkbox"/> YES <input type="checkbox"/> NO		
DESCRIPTION OF DAMAGE				
SEATING POSITION	OCCUPANTS	SAFETY EQUIPMENT	AIR BAG	INATTENTION CODES
A 1- DRIVER 2 TO 6- PASSENGERS 7- STATION WAGON REAR 8- REAR OCC. TRK. OR VAN 9- POSITION UNKNOWN 0- OTHER	A - NONE IN VEHICLE B - UNKNOWN C - LAP BELT USED D - LAP BELT NOT USED E - SHOULDER HARNESS USED F - SHOULDER HARNESS NOT USED G - LAP/SHOULDER HARNESS USED H - LAP/SHOULDER HARNESS NOT USED J - PASSIVE RESTRAINT USED K - PASSIVE RESTRAINT NOT USED P - NOT REQUIRED	CHILD RESTRAINT Q - IN VEHICLE USED R - IN VEHICLE NOT USED S - IN VEHICLE USE UNKNOWN T - IN VEHICLE IMPROPER USE U - NONE IN VEHICLE M/C BICYCLE HELMET DRIVER PASSENGER V - NO X - NO W - YES Y - YES	B - UNKNOWN L - AIR BAG DEPLOYED M - AIR BAG NOT DEPLOYED N - OTHER P - NOT REQUIRED EJECTED FROM VEHICLE 0 - NOT EJECTED 1 - FULLY EJECTED 2 - PARTIALLY EJECTED 3 - UNKNOWN	A - CELLPHONE HANDHELD B - CELLPHONE HANDSFREE C - ELECTRONIC EQUIPMENT D - RADIO / CD E - SMOKING F - EATING G - CHILDREN H - ANIMALS I - PERSONAL HYGIENE J - READING K - OTHER
ITEMS MARKED BELOW FOLLOWED BY AN ASTERISK (*) SHOULD BE EXPLAINED IN THE NARRATIVE.				
PRIMARY COLLISION FACTOR	TRAFFIC CONTROL DEVICES	SPECIAL INFORMATION	MOVEMENT PRECEDING COLLISION	
A VIO SECTION VIOLATED: <input type="checkbox"/> YES <input type="checkbox"/> NO B OTHER IMPROPER DRIVING*: <input checked="" type="checkbox"/> C OTHER THAN DRIVER* <input type="checkbox"/> D UNKNOWN*	A CONTROLS FUNCTIONING B CONTROLS NOT FUNCTIONING* C CONTROLS OBSCURED <input checked="" type="checkbox"/> D NO CONTROLS PRESENT / *MOTOR*	A HAZARDOUS MATERIAL B CELL PHONE HANDHELD IN USE <input checked="" type="checkbox"/> C CELL PHONE HANDSFREE IN USE D CELL PHONE NOT IN USE E SCHOOL BUS RELATED F 75 FT MOTOR/TRUCK COMBO G 32 FT TRAILER COMBO H I J K L M N O	A STOPPED B PROCEEDING STRAIGHT <input checked="" type="checkbox"/> C RAN OFF ROAD D MAKING RIGHT TURN E MAKING LEFT TURN F MAKING U TURN G BACKING H SLOWING / STOPPING I PASSING OTHER VEHICLE J CHANGING LANES K PARKING MANEUVER L ENTERING TRAFFIC M OTHER UNSAFE TURNING N XING INTO OPPOSING LANE O PARKED P MERGING Q TRAVELING WRONG WAY R OTHER*:	
WEATHER (MARK 1 TO 2 ITEMS) <input checked="" type="checkbox"/> A CLEAR <input type="checkbox"/> B CLOUDY <input type="checkbox"/> C RAINING <input type="checkbox"/> D SNOWING <input type="checkbox"/> E FOG / VISIBILITY FT. <input type="checkbox"/> F OTHER*: <input type="checkbox"/> G WIND	TYPE OF COLLISION A HEAD - ON <input checked="" type="checkbox"/> B SIDE SWIPE C REAR END D BROADSIDE <input checked="" type="checkbox"/> E HIT OBJECT F OVERTURNED G VEHICLE / PEDESTRIAN H OTHER*:	OTHER ASSOCIATED FACTOR(S) (MARK 1 TO 2 ITEMS) A VIO SECTION VIOLATION: <input type="checkbox"/> YES <input type="checkbox"/> NO B VIO SECTION VIOLATION: <input type="checkbox"/> YES <input type="checkbox"/> NO C VIO SECTION VIOLATION: <input type="checkbox"/> YES <input type="checkbox"/> NO <input checked="" type="checkbox"/> D [REDACTED] E VISION OBSCUREMENT: F INATTENTION*: G STOP & GO TRAFFIC H ENTERING / LEAVING RAMP I PREVIOUS COLLISION J UNFAMILIAR WITH ROAD K DEFECTIVE VEH. EQUIP.: <input type="checkbox"/> YES <input type="checkbox"/> NO L UNINVOLVED VEHICLE M OTHER*: N NONE APPARENT O RUNAWAY VEHICLE	SOBRIETY - DRUG PHYSICAL (MARK 1 TO 2 ITEMS) A HAD NOT BEEN DRINKING B HBD - UNDER THE INFLUENCE C HBD - NOT UNDER INFLUENCE* D HBD - IMPAIRMENT UNKNOWN* E UNDER DRUG INFLUENCE* F IMPAIRMENT - PHYSICAL* G IMPAIRMENT NOT KNOWN H NOT APPLICABLE I SLEEPY / FATIGUED*	
LIGHTING <input checked="" type="checkbox"/> A DAYLIGHT <input type="checkbox"/> B DUSK - DAWN <input type="checkbox"/> C DARK - STREET LIGHTS <input type="checkbox"/> D DARK - NO STREET LIGHTS <input type="checkbox"/> E DARK - STREET LIGHTS NOT FUNCTIONING* ROADWAY SURFACE <input checked="" type="checkbox"/> A DRY <input type="checkbox"/> B WET <input type="checkbox"/> C SNOWY - ICY <input type="checkbox"/> D SLIPPERY (MUDDY, OILY, ETC.)	MOTOR VEHICLE INVOLVED WITH A NON - COLLISION B PEDESTRIAN <input checked="" type="checkbox"/> C OTHER MOTOR VEHICLE <input type="checkbox"/> D MOTOR VEHICLE ON OTHER ROADWAY <input type="checkbox"/> E PARKED MOTOR VEHICLE <input type="checkbox"/> F TRAIN <input type="checkbox"/> G BICYCLE <input type="checkbox"/> H ANIMAL: <input type="checkbox"/> I FIXED OBJECT: <input checked="" type="checkbox"/> J OTHER OBJECT: TREE BRANCH	ROADWAY CONDITIONS (MARK 1 TO 2 ITEMS) <input type="checkbox"/> A HOLES, DEEP RUT* <input type="checkbox"/> B LOOSE MATERIAL ON ROADWAY* <input type="checkbox"/> C OBSTRUCTION ON ROADWAY* <input type="checkbox"/> D CONSTRUCTION - REPAIR ZONE <input type="checkbox"/> E REDUCED ROADWAY WIDTH <input type="checkbox"/> F FLOODED* <input type="checkbox"/> G OTHER*: <input checked="" type="checkbox"/> H NO UNUSUAL CONDITIONS		
PEDESTRIAN'S ACTIONS <input checked="" type="checkbox"/> A NO PEDESTRIANS INVOLVED <input type="checkbox"/> B CROSSING IN CROSSWALK - AT INTERSECTION <input type="checkbox"/> C CROSSING IN CROSSWALK - NOT AT INTERSECTION <input type="checkbox"/> D CROSSING - NOT IN CROSSWALK <input type="checkbox"/> E IN ROAD - INCLUDES SHOULDER <input type="checkbox"/> F NOT IN ROAD <input checked="" type="checkbox"/> G APPROACHING / LEAVING SCHOOL BUS				
SKETCH <div style="text-align: center;"> INDICATE NORTH </div>		MISCELLANEOUS		

An Internationally Accredited Agency

Chp555_0411.pdf



ANAHEIM POLICE DEPARTMENT

GO# 2018-153417
CLOSED - NO FURTHER
ACTION

GENERAL OFFENSE HARDCOPY OTHER AUTHORIZED

(TRAFFIC-0 TRAFFIC COLLISION/INJURY-901)

STATE OF CALIFORNIA
DEPARTMENT OF CALIFORNIA HIGHWAY PATROL
INJURED / WITNESS / PASSENGERS
CHP 555 Page 3 (Rev. 6-17) OPI 060

Page 3 of 5

DATE OF COLLISION (MO. DAY YEAR) 10-3-18			TIME (2400) 1655		NCIC # 3001		OFFICER I.D. 1032		NUMBER 18-153417								
EXTENT OF INJURY ("X" ONE)												INJURED WAS ("X" ONE)					
<input type="checkbox"/> WITNESS ONLY	<input type="checkbox"/> PASSENGER ONLY	AGE 36	SEX F	FATAL INJURY	SUSPECTED SERIOUS INJURY	SUSPECTED MINOR INJURY	POSSIBLE INJURY	DRIVER	PASS.	PED.	BICYCLIST	OTHER	PARTY NUMBER	SEAT POS.	AIR BAG	SAFETY EQUIP.	EJECTED
													1	1	L	G	Ø
NAME / D.O.B. / ADDRESS P/I																	
(INJURED ONLY) TRANSPORTED BY: REFUSED												EMS RUN NUMBER ADD T-10/CARE #9			TAKEN TO: WILL SEEK OWN MEDICAL		
DESCRIBE INJURIES ABRASSION TO LIFEGEAR ADD FORT HANDS FROM AIR BAG.																	
<input type="checkbox"/> VICTIM OF VIOLENT CRIME NOTIFIED																	
NAME / D.O.B. / ADDRESS KEVIN MCKEOWN /																	
(INJURED ONLY) TRANSPORTED BY:												EMS RUN NUMBER			TAKEN TO: FULLERTON CROSS		
DESCRIBE INJURIES																	
<input type="checkbox"/> VICTIM OF VIOLENT CRIME NOTIFIED																	
NAME / D.O.B. / ADDRESS																	
(INJURED ONLY) TRANSPORTED BY:												EMS RUN NUMBER			TAKEN TO:		
DESCRIBE INJURIES																	
<input type="checkbox"/> VICTIM OF VIOLENT CRIME NOTIFIED																	
NAME / D.O.B. / ADDRESS																	
(INJURED ONLY) TRANSPORTED BY:												EMS RUN NUMBER			TAKEN TO:		
DESCRIBE INJURIES																	
<input type="checkbox"/> VICTIM OF VIOLENT CRIME NOTIFIED																	
NAME / D.O.B. / ADDRESS																	
(INJURED ONLY) TRANSPORTED BY:												EMS RUN NUMBER			TAKEN TO:		
DESCRIBE INJURIES																	
<input type="checkbox"/> VICTIM OF VIOLENT CRIME NOTIFIED																	
NAME / D.O.B. / ADDRESS																	
(INJURED ONLY) TRANSPORTED BY:												EMS RUN NUMBER			TAKEN TO:		
DESCRIBE INJURIES																	
<input type="checkbox"/> VICTIM OF VIOLENT CRIME NOTIFIED																	
NAME / D.O.B. / ADDRESS																	
(INJURED ONLY) TRANSPORTED BY:												EMS RUN NUMBER			TAKEN TO:		
DESCRIBE INJURIES																	
<input type="checkbox"/> VICTIM OF VIOLENT CRIME NOTIFIED																	
PREPARER'S NAME C. EPYANT																	
I.D. NUMBER 1032		MO. DAY YEAR 10-3-18		REVIEWER'S NAME R. ALVARADO		MO. DAY YEAR 10-3-18											

An Internationally Accredited Agency

20518 CHP555_0617.pdf



ANAHEIM POLICE DEPARTMENT

GO# 2018-153417
CLOSED - NO FURTHER
ACTION

GENERAL OFFENSE HARDCOPY OTHER AUTHORIZED

(TRAFFIC-0 TRAFFIC COLLISION/INJURY-901)

ANAHEIM POLICE DEPARTMENT COLLISION NARRATIVE

Page 4 of 5

DATE 10-03-2018 TIME 1655 NCIC 3001 OFFICER #1032 GO# 18-153417

Area of Impact How Established: Skids ___ Damage x Debris x Statements x Points of Rest ___
Measurement: Roll-A-Tape x Tape Measure Paces Other

#1	445 Feet, East of the East Curb Prolongation of Mosswood Dr & 20 Feet, North of the South Curb Line of La Palma Ave
#2	Feet, --- of the Curb Line of & Feet, --- of the Curb Line of
#3	Feet, --- of the Curb Line of & Feet, --- of the Curb Line of
#4	Feet, --- of the Curb Line of & Feet, --- of the Curb Line of

1 **Statements:**

2 P/1-Loo was traveling E/B in the #1 lane of La Palma Ave. at about 40 mph, with no other vehicles in front
3 of her vehicle. After passing through the intersection of Mosswood Dr. P/1 observed a large branch from a
4 pine tree on the south side of La Palma Ave. start to fall towards the street. P/1 estimates she was
5 approximately 75 feet west of the described tree when it began to fall. P/1 thought to brake, but she was
6 unable to do much except to drive forward due to how fast the tree branch was falling. A portion of the
7 falling branch struck the front of her vehicle and the air bags were deployed. P/1 came to a complete stop
8 just east of where her vehicle struck the tree branch.

9
10 W/1-Kevin Mc Keown, Supervising Park Ranger/County of Orange Parks, arrived on scene. He initiated his
11 investigation and confirmed the described tree was the property of Yorba Regional Park, County of Orange.
12 W/1 requested West Coast Arborist to respond for the downed tree branch, which was blocking all of
13 eastbound lanes of La Palma Ave. He advised the county incident number of 18-513.

14
15 **Additional Information:**

16 BWC was used and uploaded into Axon. Photos taken at the scene were entered into DIMS.

17
18 **Recommendations:**

19 No further follow up requested.

Officer C. Bryant #1032

Reviewer's name R. ALEXANDER #0000
100518



ANAHEIM POLICE DEPARTMENT

GO# 2018-153417
CLOSED - NO FURTHER
ACTION

GENERAL OFFENSE HARDCOPY

OTHER AUTHORIZED

(TRAFFIC-0 TRAFFIC COLLISION/INJURY-901)

STATE OF CALIFORNIA
DEPARTMENT OF CALIFORNIA HIGHWAY PATROL
FACTUAL DIAGRAM
CHP 555 Page 4 (Rev. 6-17) OPI 060

Page 5 of 5

DATE OF COLLISION (MO. DAY YEAR)	TIME (HOUR)	MOVC #	OFFICER I.D.	NUMBER
10-3-18	1655	3001	1032	18-153417

ALL MEASUREMENTS ARE APPROXIMATE AND NOT TO SCALE UNLESS STATED (SCALE =)

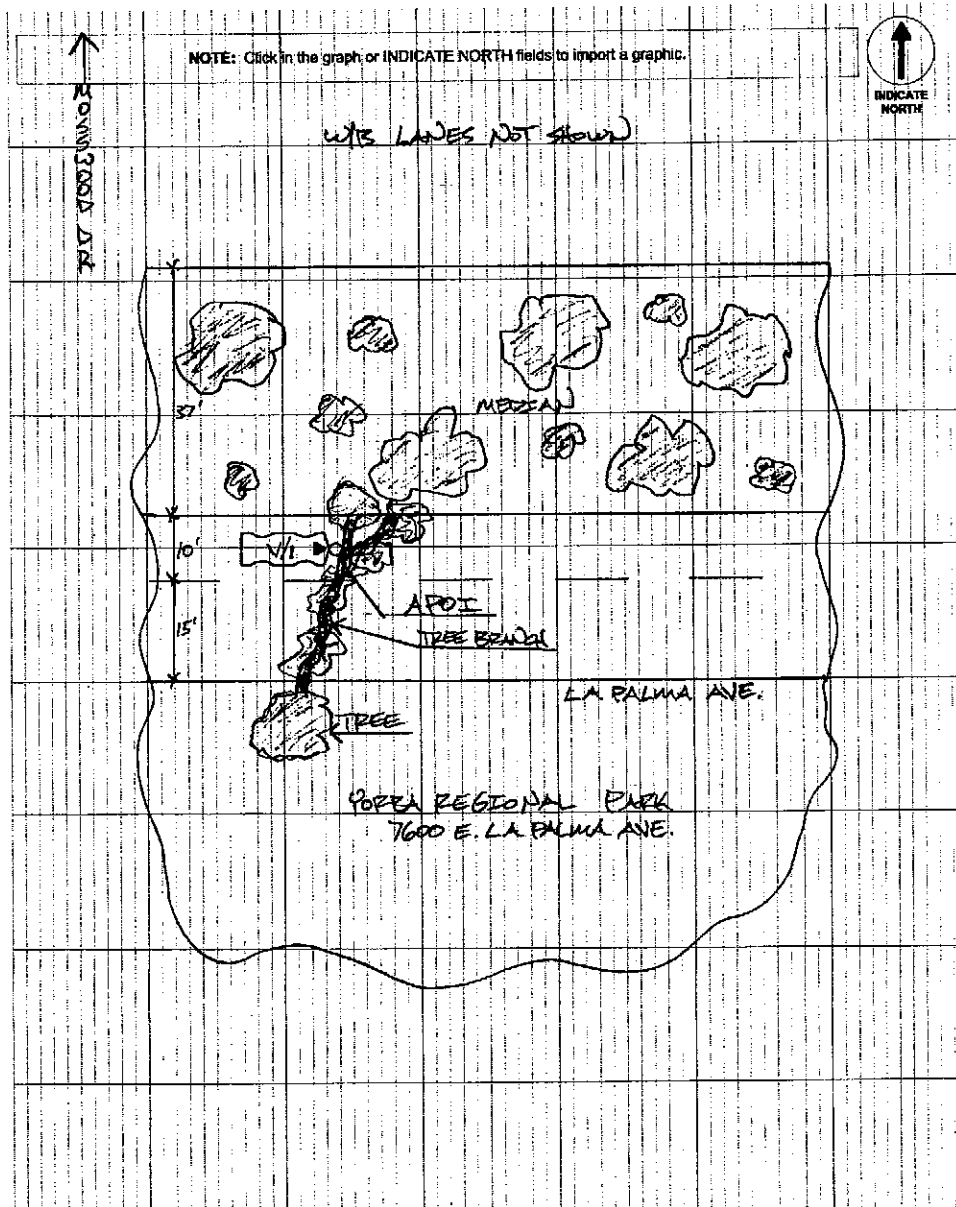

PREPARED BY C. BRYANT	ID. NUMBER 10-3-18	MO. DAY YEAR	REVIEWER'S NAME R. ...	MO. DAY YEAR 10-30
--------------------------	-----------------------	--------------	---------------------------	-----------------------

An Internationally Accredited Agency

100518

Chp555_0617.pdf



ANAHEIM POLICE DEPARTMENT

GENERAL OFFENSE HARDCOPY

OTHER AUTHORIZED

(TRAFFIC-0 TRAFFIC COLLISION/INJURY-901)

GO# 2018-153417
CLOSED - NO FURTHER
ACTION

***** END OF HARDCOPY *****

Jennifer L. Hall

Subject: Julie Loo - Public Records Request
Attachments: J, Loo - Public Records Rqst (Anaheim & OC) 102418.pdf

From: Jennifer Vo
Sent: Wednesday, October 24, 2018 9:56 AM
To: Linda Andal <landal@anaheim.net>
Cc: Phillip Nghiem Briseria Gomez
Subject: Julie Loo - Public Records Request

Good morning:

Please see attached request. Thank you

Jennifer Vo, Legal Assistant

Hess & Nghiem

Santa Ana, CA 92705

