

BY DEVELOPER/CONTRACTOR:

- ① PROVIDE AND INSTALL NEW 1600 AMP, 480Y/277V, 3Ø, 4W, UNDERGROUND PULL SECTION, PER ELECTRIC UTILITY SERVICE EQUIPMENT REQUIREMENTS COMMITTEE WITH FIVE (5) **TWO ALLEN SET SCREW** AL/CU RATED CONNECTORS DOUBLE BOLTED TO BUS PER PHASE AND NEUTRAL, PER CU1600-21.
PROVIDE AND INSTALL NEW 1600 AMP, 480Y/277V, 3Ø, 4W METER PANEL, PER EUSERC REQUIREMENTS.
PANEL MANUFACTURER TO SUBMIT TO THE CITY OF ANAHEIM, ELECTRICAL ENGINEERING DIVISION 4 COPIES OF THE ELECTRICAL SERVICE PANEL CONSTRUCTION DRAWINGS FOR APPROVAL. **(NOTE: SWITCHGEAR TO BE APPROVED BY ANAHEIM UTILITIES BEFORE INSTALLATION)**
CITY OF ANAHEIM
201 S. ANAHEIM BLVD. SUITE 701
ANAHEIM, CA 92805
- ② CONTACT ELECTRICAL UTILITIES INSPECTOR FOR INSPECTION AND TO SCHEDULE PROJECT WITH UTILITIES SERVICE CREW.
- ③ PROVIDE AND INSTALL SIX (6) - 4" GRAY PVC SCHEDULE 40 SERVICE CONDUIT, CONCRETE ENCASED (5 SACK MIX) PER CU1500-5, CU1600-4A, CU1600-96C, CU1600-96M, 36" MIN. DEEP FROM FINISHED GRADE, WITH 4-750 MCM AL XHHW-2 OR EQUAL CONDUCTORS IN EACH OF FIVE (5) CONDUITS FROM UNDERGROUND PULL SECTION TO PADMOUNT TRANSFORMER PER CU1600-21. ONE (1) SPARE CONDUIT WITH 3/8" POLY ROPE PER CU1600-96L.
- ④ ALL TRENCHING AND BACKFILLING SHALL BE PER APU ELECTRICAL CONSTRUCTION STANDARDS.
- ⑤ PROVIDE AND INSTALL NEW 5' X 8.5' PADMOUNT VAULT WITH BASE AND 8' X 10' TRANSFORMER PAD WITH GROUND ROD PER CU1600-20. SEE DETAIL 'A' FOR EASEMENT DETAILS.
NOTE: METAL LID TO FACE WEST FOR TRANSFORMER.
- ⑥ PROVIDE AND INSTALL ONE (1) - 4" GRAY PVC SCHEDULE 40 PRIMARY CONDUIT, CONCRETE ENCASED (5 SACK MIX) WITH 3/8" POLY ROPE, 48" MIN. DEEP FROM FINISHED GRADE FROM POLE TO PADMOUNT TRANSFORMER PER CU1600-4A, CU1600-96L, AND CU1600-96M.
NOTE: CONTRACTOR TO PROVIDE CONDUIT UP TO THE BASE OF POLE. A RIGHT OF WAY CONSTRUCTION PERMIT WILL BE REQUIRED FROM THE PUBLIC WORKS DEPARTMENT FOR ANY WORK TO BE DONE ON THE PUBLIC RIGHT OF WAY. SEE ITEM 11 OF GENERAL UNDERGROUND NOTES.
- ⑦ ALL TRENCHING AND BACKFILLING SHALL BE PER APU ELECTRICAL CONSTRUCTION STANDARDS.
- ⑧ INSTALL REMOVABLE PROTECTIVE POSTS PER CU1600-9. PROTECTIVE POST SPACING TO BE DETERMINED BY ELECTRICAL UTILITIES INSPECTOR.
- ⑨ REMOVE EXISTING 400 AMP PANEL, 208Y/120V, 3Ø, 4W AND EQUIPMENT.
- ⑩ COORDINATE WITH ELECTRICAL UTILITIES INSPECTOR PRIOR TO REMOVING EXISTING SWITCHGEAR FOR REMOVAL OF METERING EQUIPMENT.

BY ANAHEIM PUBLIC UTILITIES:

- A TERMINATE CONTRACTOR SUPPLIED SERVICE CABLES IN PADMOUNT TRANSFORMER AND ENERGIZE SERVICE.
- B INSTALL NEW PADMOUNT TRANSFORMER, 750 KVA, FUSED, 12KV-480Y/277V, 3Ø, 4W.
- C INSTALL 15 KV #1/0 ALUMINUM TRIPLEX PRIMARY CABLE
- D BUILD PRIMARY RISER ON POLE
- E DE-ENERGIZE / REMOVE SECONDARY UNDERGROUND CABLE AND ABANDON EXISTING CONDUIT IN PLACE.
- F **OUT POLE:**
2 - 10' CROSS ARM
2 - V-BRACE
14 - 12 KV DEAD-END BELLS
8 - #2 DEAD END SHOES
1 - CLAMP TOP
- IN POLE:**
2 - 10' CROSS ARM
2 - V-BRACE
8 - 15 KV SILICON DEAD-END W/ PIN
8 - 15 KV #2 ASOR DEAD-END SHOE
4 - 28 KV SILICON POST TYPE CLAMP TOP W/ PIN
1 - 7/16" SIDE DOWN GUY (SEE GUY DETAIL)
- TRANSFER POLE:**
#2 ASOR CONDUCTORS TO NEW 10' CROSS ARMS

RISER DETAILS

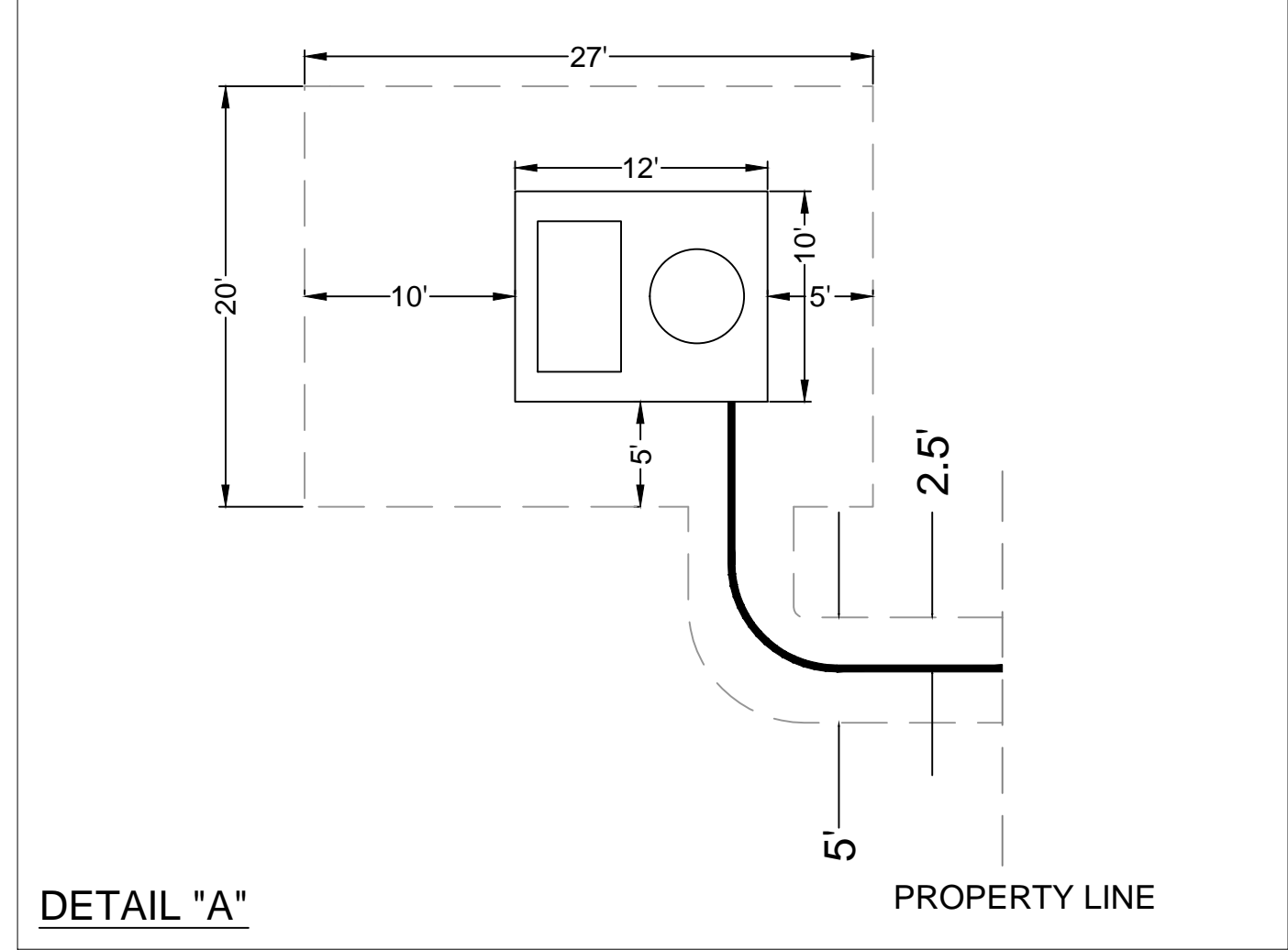
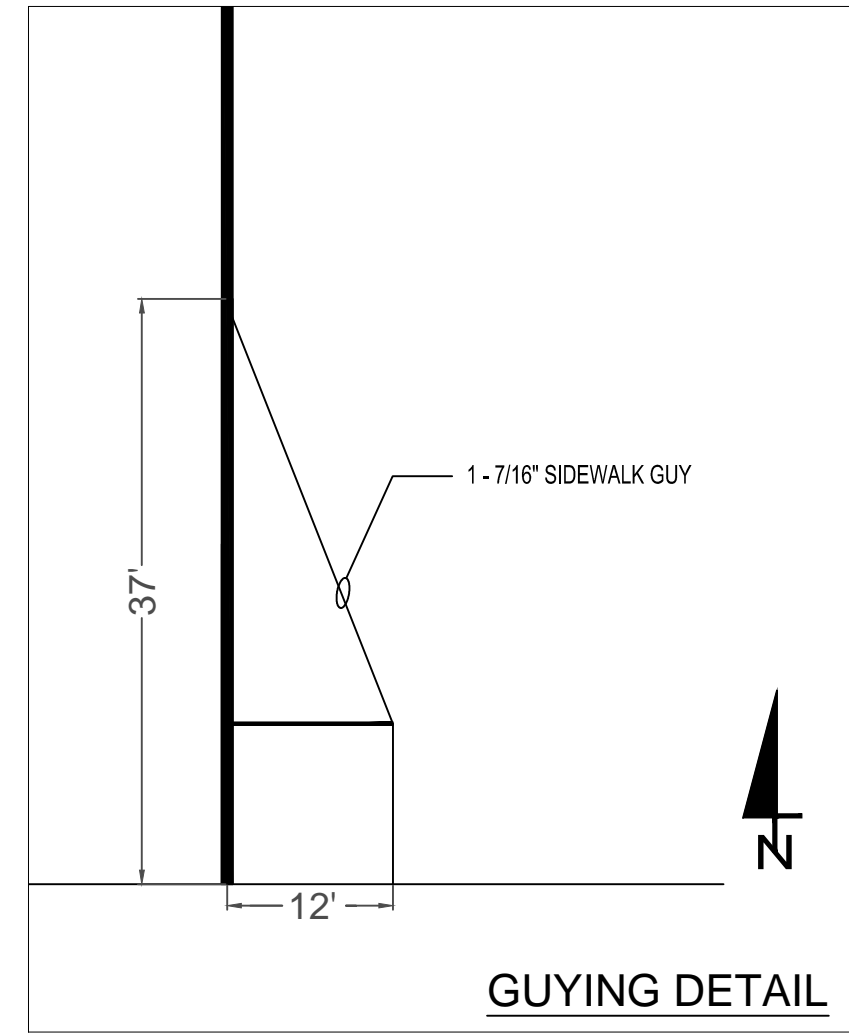
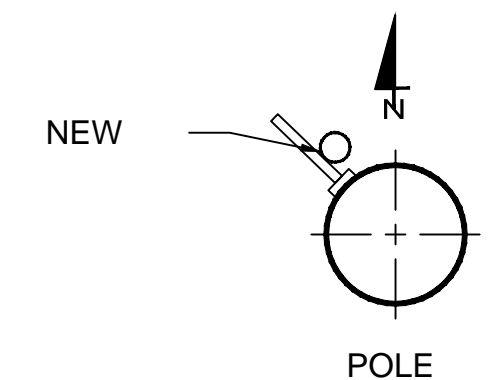

ELECTRICAL EASEMENT REQUIREMENTS:

- PLEASE RETURN TO THIS OFFICE AS SOON AS POSSIBLE. **DETAIL "B"**
1. WRITTEN LEGAL DESCRIPTION OF EASEMENT AND ENGINEERED DRAWING, TO BE PREPARED, STAMPED AND SIGNED BY A LICENSED LAND SURVEYOR OR QUALIFIED CIVIL ENGINEER (LICENSED BEFORE JANUARY 1, 1982).
 2. CLOSURE CALCULATIONS, IF LEGAL DESCRIPTION IS BY METES AND BOUNDS.
 3. ALL DOCUMENTS TO BE SUBMITTED ON 8.5" X 11" PAPER.

CONTACT INFORMATION

CITY OF ANAHEIM
PUBLIC UTILITIES DEPARTMENT
ELECTRICAL ENGINEERING DIVISION

12KV UCID SYSTEM

PROJECT ADDRESS

PROGRAM:	DRAWING NO.	REV.
PROJECT:		
SCALE:		
SHEET 1 OF 1		0

REFERENCES	NO.	DATE	REVISIONS	FIELD W/O	DRAWN	DESIGNER	ENGINEER	PE	FIELD SUPT.	ENGR MGR.

**FOR REFERENCE ONLY
NOT FOR CONSTRUCTION**



NOTICE TO CONTRACTOR:
THE EXISTENCE AND LOCATION OF ANY UNDERGROUND UTILITY PIPES OR STRUCTURES WAS OBTAINED BY A SEARCH OF THE AVAILABLE RECORDS. ADDITIONAL UNDERGROUND FACILITIES MAY EXIST, OR THE LOCATION OF THE FACILITIES MAY DIFFER FROM THE LOCATIONS SHOWN ON THESE PLANS. THE CONTRACTOR SHALL, AT HIS OWN EXPENSE, DETERMINE THE EXACT LOCATION OF ALL SUCH UNDERGROUND FACILITIES PRIOR TO COMMENCEMENT OF ANY WORK OR ANY ACTION WHICH MAY DAMAGE SUCH FACILITIES OR INTERFERE WITH THEIR CONTINUOUS AND PROPER OPERATION.